

LGI / SCIENCE WING - RENOVATIONS: PHASE 1

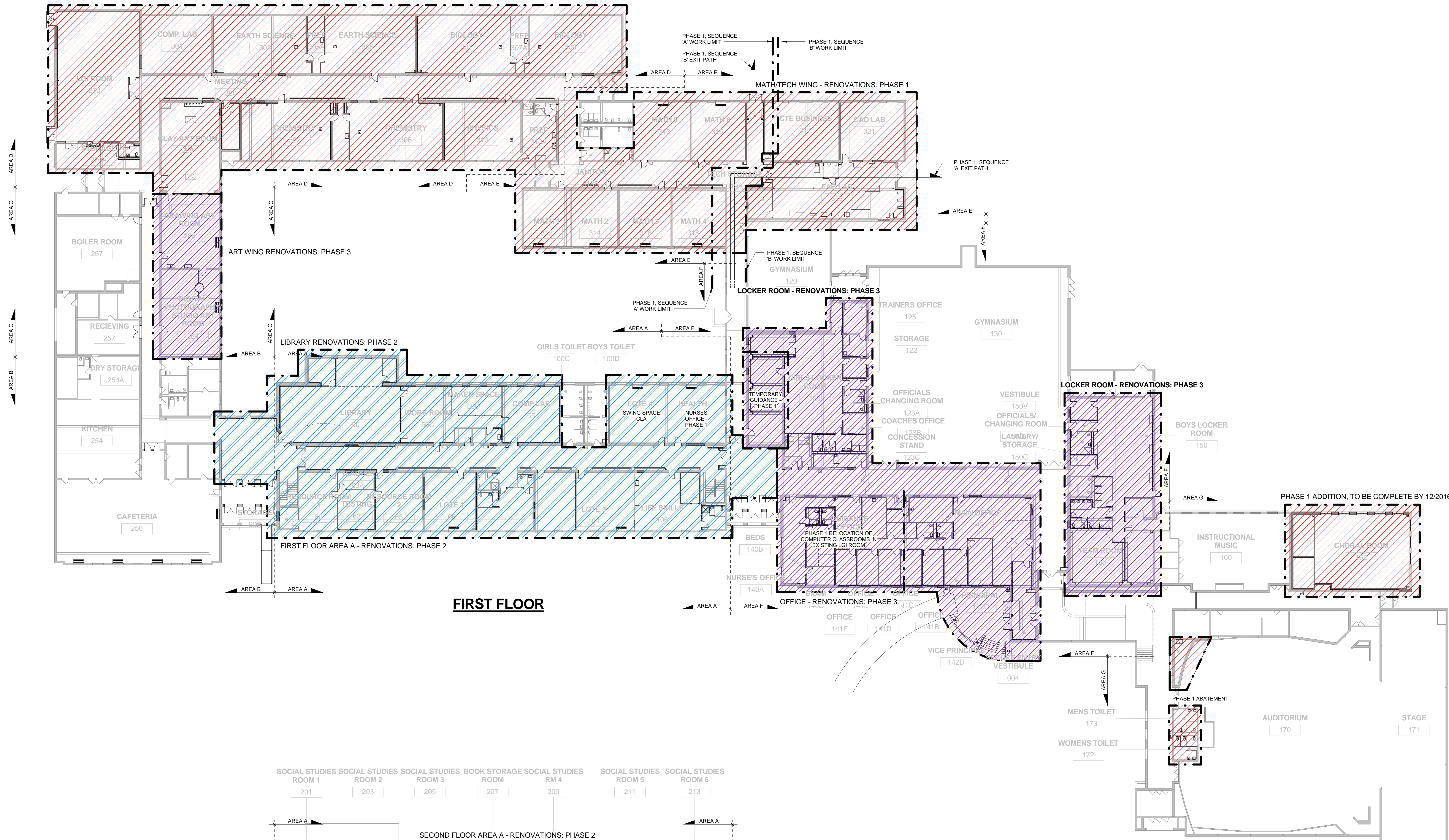

FIRST FLOOR

SECOND FLOOR

- WORK PHASING GENERAL NOTES**
1. MAINTAIN EXISTING BUILDING EXITS DURING CONSTRUCTION AND AT NEW ADDITION AND ENTRANCE CANOPY STRUCTURE. PROVIDE SAFE WALKING PATHS WITH OVERHEAD PROTECTION WHEN WORK IS TO TAKE PLACE DURING OCCUPIED TIMES. ESTABLISH NEW EXIT CORRIDOR AT FAR LAB ALTERATION PRIOR TO ELIMINATING EXISTING EXIT CORRIDOR. PHASE 1 SHALL BE SEQUENCED AS SHOWN TO ALWAYS MAINTAIN AN EXIT PATH IN THIS AREA AVAILABLE TO BUILDING OCCUPANTS. ABATEMENT OPERATIONS SHALL NOT SHARE EXITS WITH OCCUPIED AREAS OF THE BUILDING. ASSUME THAT ALL EXITS ADJACENT TO AREAS NOT IN THE CURRENT PHASE AREA OCCUPIED (EX. LOBBIES). AREA A, PHASE 2 ABATEMENT SHALL ESTABLISH BUILDING EXITS DEDICATED TO ABATEMENT OPERATIONS, NOT SHOWN ON DRAWINGS (EX. WINDOW ACCESS). AREA A LOBBIES SHALL BE CONFINED TO SUMMER NON-OCCUPIED DURATION AS A RESULT OF RESTRICTIONS NOTED.
 2. ASSUME ABATEMENT OPERATIONS AND DURATIONS AT THE START OF EACH PHASE AND PRIOR TO THE WORK OF ANY OTHER TRADE. ABATEMENT SCHEDULES AND DURATIONS ARE SUBJECT TO COORDINATION WITH OTHER'S OCCUPANCY AND REQUIREMENTS AND WORK OF OTHER TRADES.
 3. G.C. SHALL BE RESPONSIBLE FOR NON-COMBUSTIBLE AND DUST PROOF CONSTRUCTION SEPARATION BARRIERS AT LIMITS OF EACH PHASE IN ADDITION TO THOSE NECESSARY FOR ABATEMENT. DEAD ENDING CORRIDORS MUST BE AVOIDED. WORK OF TRADES WHICH EXTENDS OUTSIDE OF THE CONFINES SHOWN FOR EACH PHASE, DUE TO THE NATURE OF THE WORK, SEQUENCING, EQUIPMENT OPERATION AND WIRING SHALL BE SPECIFICALLY COORDINATED WITH THE ARCHITECT AND OWNER PRIOR TO COMMENCEMENT OF SUCH WORK.

PHASING LEGEND

	PHASE 1 JULY 2016 - FEBRUARY 2017 DMS ENTRY - TBD
	PHASE 2 MARCH 2017 - FEBRUARY 2018
	PHASE 3 JULY 2017 - JUNE 2018 DMS ENTRY - TBD SITE WORK KCH HEATING AND ENTRY HS NEW LOCKERS
	PHASE LIMIT LINE, UNLESS NOTED OTHERWISE

PHASING PLAN
1" = 20'-0"



ARCHITECTURE • PLANNING • CONSULTING
234 MILL STREET SUITE 205
ROCHESTER, NY 14614 ALBANY, NY 12205
p 585.442.7010 p 518.435.2467
f 585.442.7019 f 518.435.2467



Gheen Engineering, PLLC
44 Glenridge Road • Whitesboro • NY • 13492
Ph: 315.264.0283 • Fax: 315.362.9583

SCHODER RIVERS ASSOCIATES CONSULTING ENGINEERS, P.C.
Evergreen Professional Park
453 Dixon Road, Suite 7, Bldg. 3
Queensbury, New York 12804
(518) 761-0417, FAX: (518) 761-0513

Engineered Solutions
9 Corporate Drive
Canton, NY 12025
phone: (518) 261-6479
fax: (518) 219-2837
www.esolutionspc.com



It is a violation of Title VIII, Article 147 of 1955 Education Law for any person, unless acting under the direction of a licensed architect, to alter any item on this document in any way. Any licensee who alters this document is required by law to affix his or her seal and the notation "altered by" followed by his or her signature and a specific description of the alterations made.

Key Plan

Title
MARCELLUS CENTRAL SCHOOL DISTRICT 2016 CAPITAL IMPROVEMENTS PROJECT
SED Control No.: 42-11-01-06-0-005-019

SEI Project No. 15-3019
Date 04/11/2016
Drawn By SEI
Checked By MSM
Scale As indicated

Revisions:

No.	Description	Date

FIRST AND SECOND FLOOR PHASING PLAN

BUILDING: DRAWING NUMBER:
HS A0.02